

P3215

15" Panel PC



robust design

SIMPLICITY

RELIABILITY

performance

Easy service

304/316 STAINLESS STEEL



KEY FEATURES

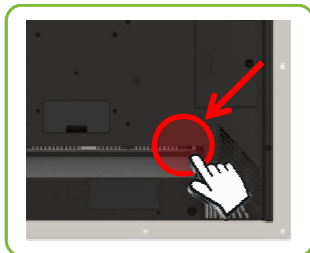

Easy Access

Discreet yet easy to access
Power Button



Cable Cover

Helps to prevent
unauthorized tampering.



IP 65

IP65 water and dust proof
protection (front only).

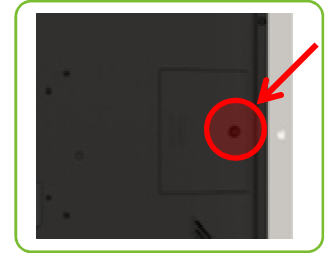

Quick HDD Access

Quick and Easy HDD access

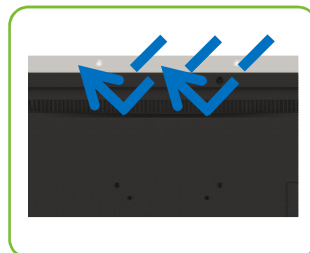

Spill Proof

Patented design prevents
liquid from getting into the
system. (For Intel Core-i3, i5, i7
desktop CPU)

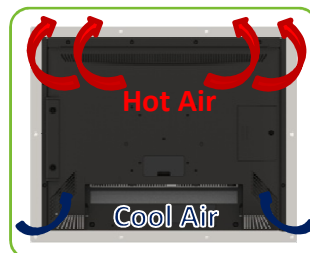

Fan-less

Aluminum Die-casting Housing
design allows heat to escape.

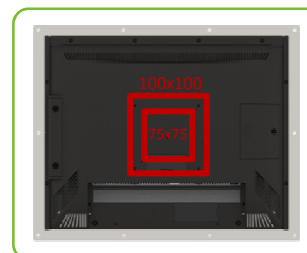

VESA Mount

Standard 75x75, 100x100 VESA
holes for pole-, wall-, and
stand- mountings

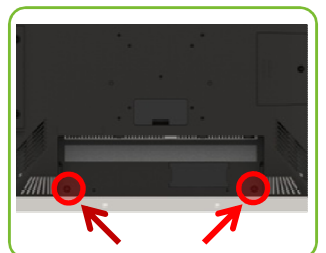

Easy Service

Just two screws to reach the
major components, such as MB,
RAM, LCD,...etc.

Made in Taiwan

PENETEK[™]
www.penetek.com

Dimension

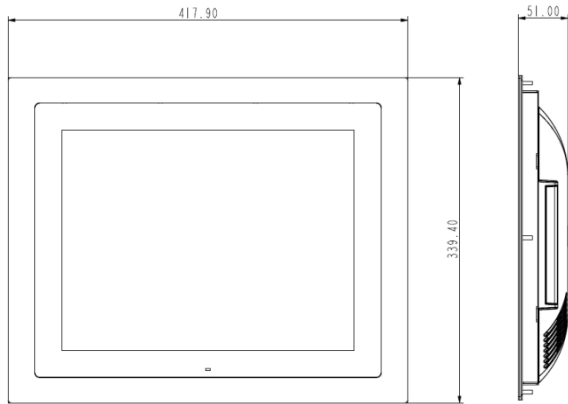

I/O Interface

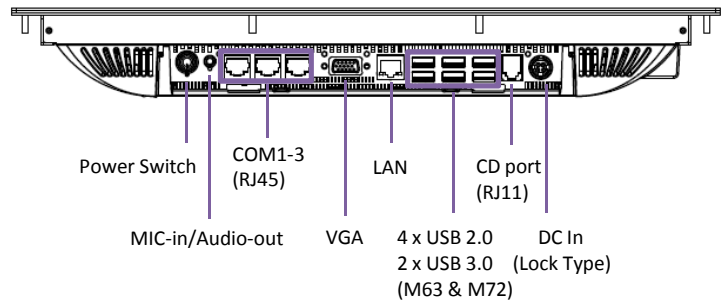

Specification

Model		P3215	
CPU Support		Intel® Haswell Core i5-4570TE 2.70GHz Core i3-4300TE 2.40GHz Pentium G3320TE 2.30GHz	Intel® Coffee Lake 8 th Gen Core i7-8700T 2.40GHz (6 Cores) 8 th Gen Core i5-8500T 2.10GHz (6 Cores) 8 th Gen Core i3-8100T 3.10GHz (4 Cores) 8 th Gen Pentium G5400T 3.10GHz (2 Cores) 8 th Gen Celeron G4900T 2.90GHz (2 Cores)
System Memory		DDR3L, SO-DIMM x 2, 4GB (Max. 16GB)	DDR4L, SO-DIMM x 2, 4GB (Max. 16GB)
Storage	HDD		1 x 2.5" HDD (Optional)
	SSD		1 x 2.5" SSD
LCD	Size	15" TFT LED LCD Panel	
	Brightness	350cd/m2 (Typ.)	
	Resolution	1024 x 768	
Touch Screen		True-Flat Projected Capacitive Touch / Resistive Touch	
Tilt Angle		0 ~ 120 degree	
External I/O Port		4 x USB 2.0 & 2 x USB 3.0 Ports	
	Rear	4 x Serial port (RJ45); (COM1~3: 0/5/12V by BIOS, COM4 by inner cable (optional))	
		1 x VGA (Power enable by BIOS; +12V)	
		1 x Cash Drawer Port (RJ11; +12V/24V)	
		1 x LAN (10/100/1000)	
		1 x MIC-In/Speaker-out (Combo Jack)	
		1 x DC In	
		1 x Power Switch	
Speaker		2 x 2W speaker (Optional)	
Power		External power adapter, 84W/12V (Lock type)	
EMC Safety		CE, FCC Class A	
Environment	Operating Temperature	0°C ~ 35°C	
	Storage Temperature	-20°C ~ 60°C	
	Operating Humidity	20% - 85% RH non condensing	
	Storage Humidity	20% - 85% RH non condensing	
Security & Reliability		N/A	TPM 2.0 (Optional)
OS Support		Windows® 7 Pro / Windows® POSReady 7 / Windows® 10 IoT / Linux per request	Windows® 10 IoT / Linux per request
Dimension (W x D x H)		417.90 x 51.00 x 339.40 mm	
Weight (N.W./G.W.)		8 kgs(N.W.)/9 kgs(G.W.)	
Wall Mount		VESA 100 x 100mm	
Peripherals	Scanner	2D Scanner (Optional)	